

BLDG "A"  
RE. 11A2.01

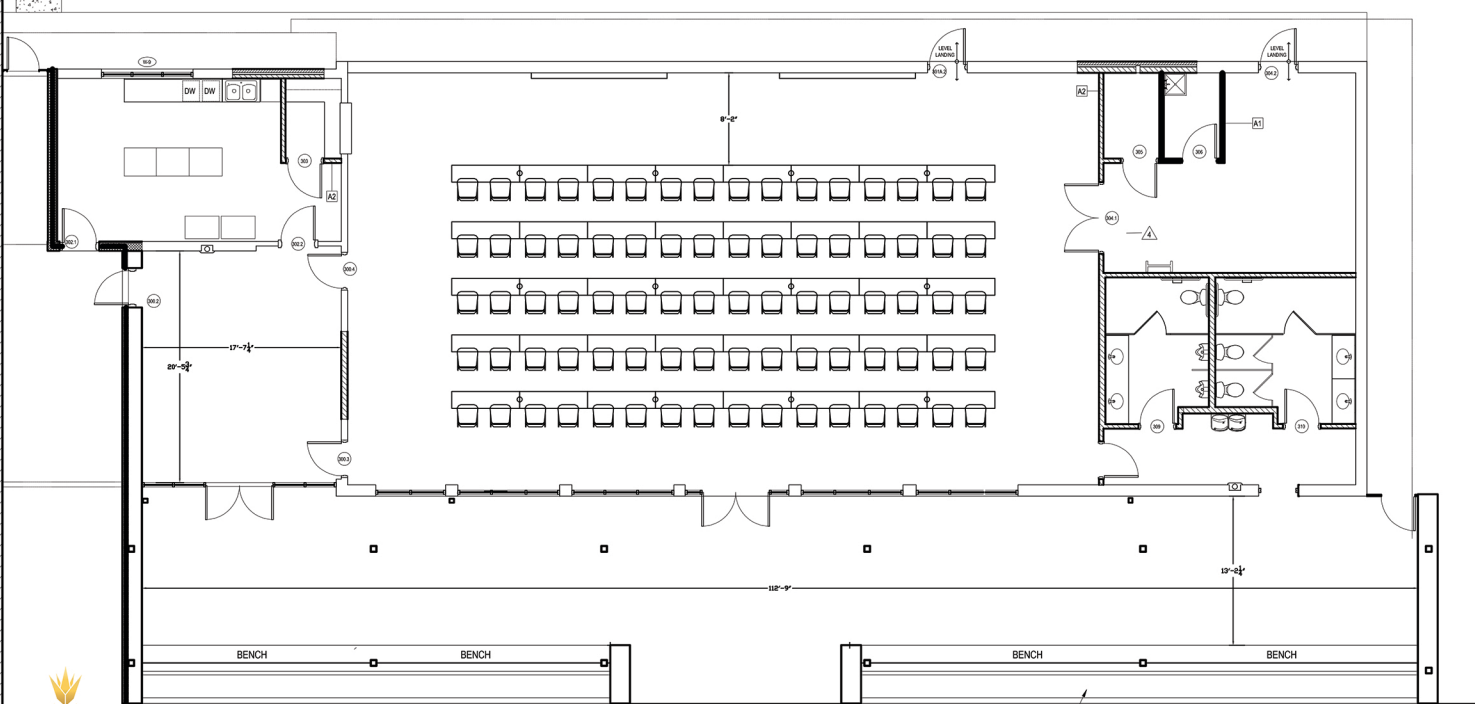

**THE EXECUTIVE HALL | SEATING CAPACITY: 80 PEOPLE**

PLANTER

FIRE-100

BLDG "A"  
RE: 1/A2.01

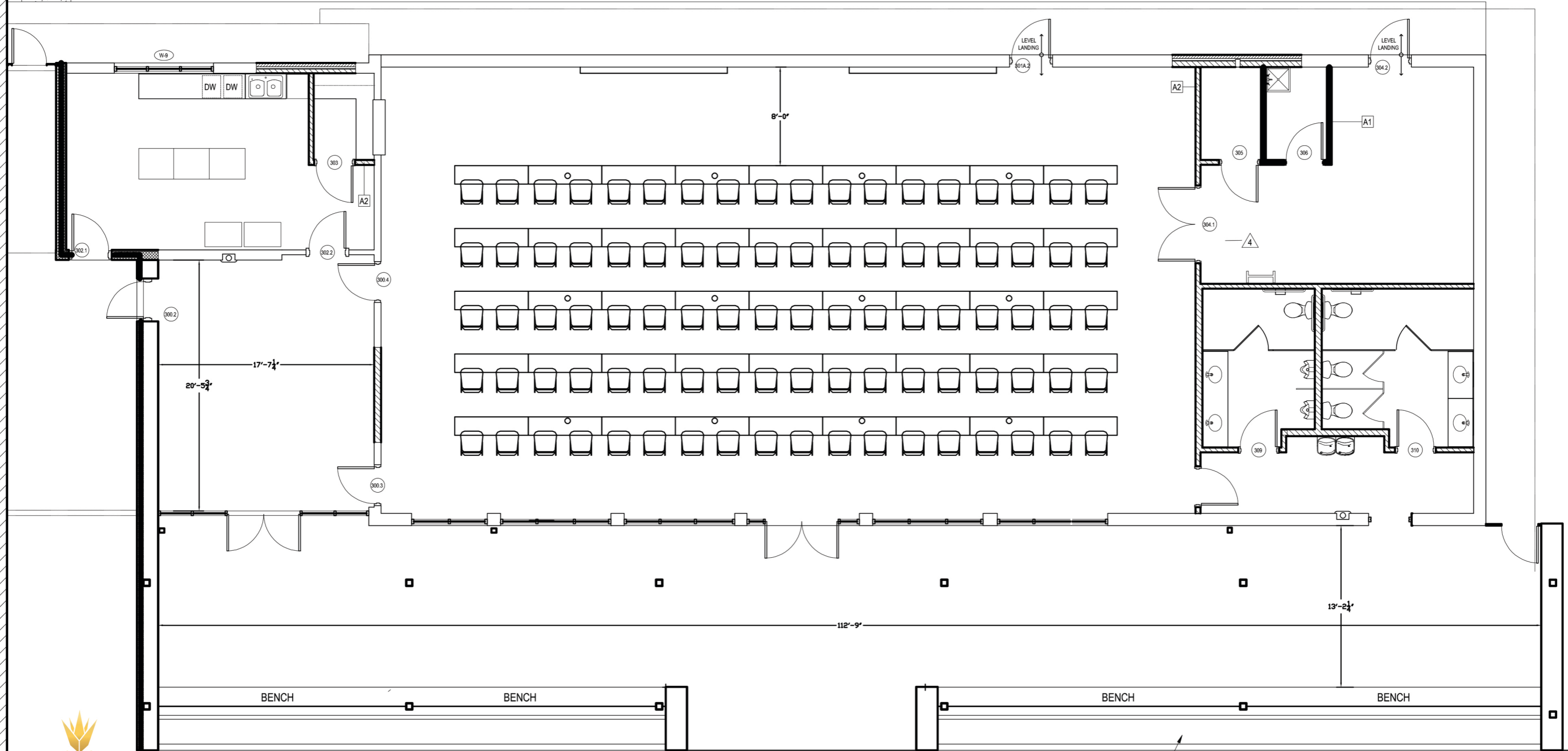

**THE EXECUTIVE HALL | SEATING CAPACITY: 90 PEOPLE**

PLANTER

FFE = 0.00



BLDG "A"  
RE: 1/A2.01

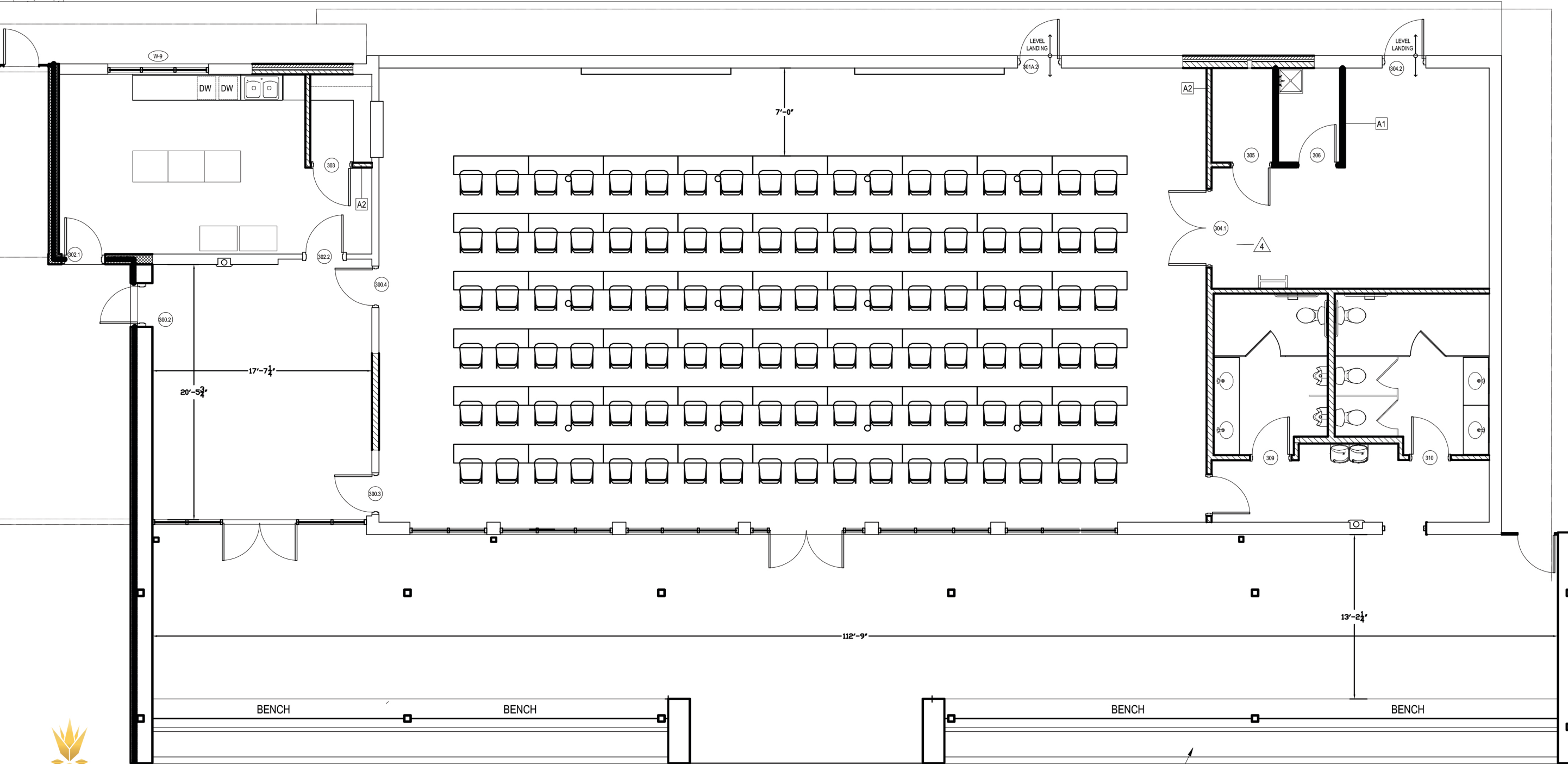

**THE EXECUTIVE HALL | SEATING CAPACITY MAX-ED OUT: 108 PEOPLE**

PLANTER

FFE = 0.00



BLDG "A"  
RE: 1/A2.01



**THE EXECUTIVE HALL | SEATING CAPACITY SET UP FOR BAND: 112 PEOPLE**

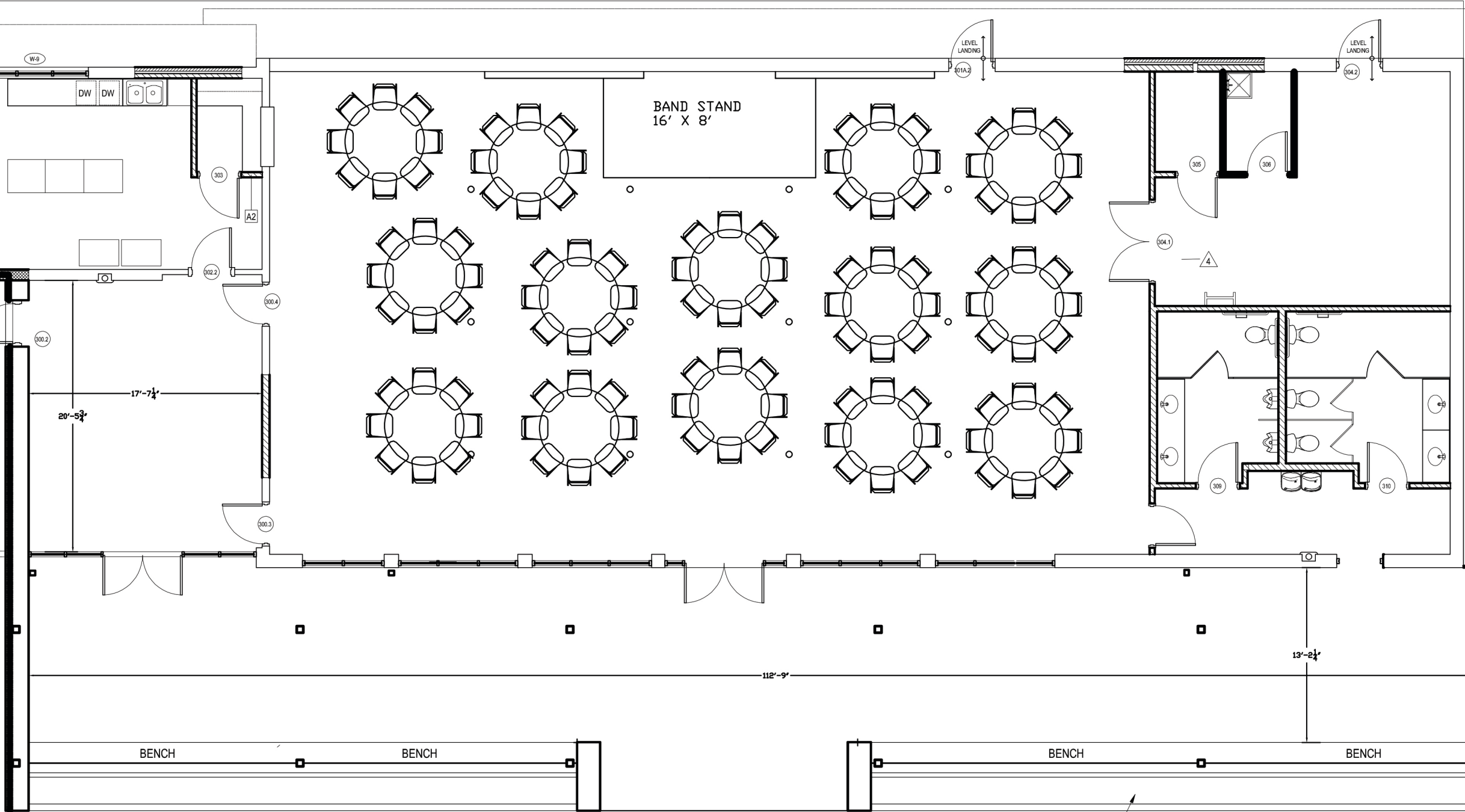

PLANTER

FFE = 0.00

BLDG 7A  
RE 1/A2.01



**THE EXECUTIVE HALL | SEATING CAPACITY WITH 15 ROUND TABLES: 120 PEOPLE**

PLANTER

